

Gresham Gas Sampling Pump

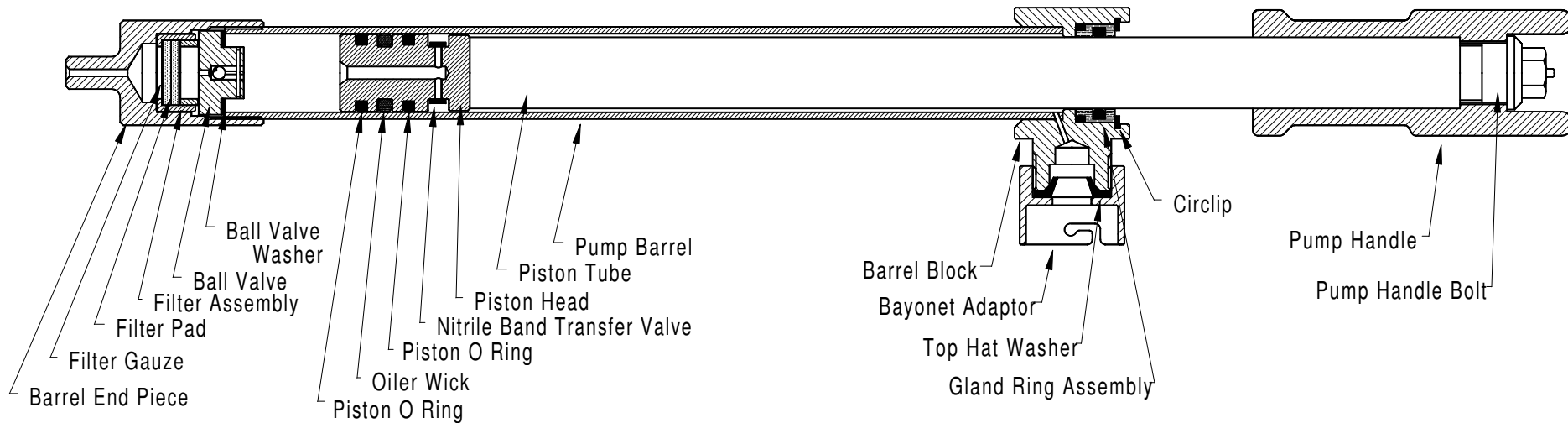

Dismantling Instructions

- 1) Fully extend Pump and hold the piston in a vice using Soft Jaws so the tube is not damaged. (Very Important.)
- 2) Undo Pump Handle Bolt and Remove the Handle.
- 3) Hold the Barrel Block in the Vice, (use Soft Jaws as before), undo the Barrel End Piece.
- 4) The Ball Valve and Filter Assembly can now be removed.
- 5) With the Pump still in the vice the Piston can be pushed out of the Pump Barrel giving access to the Piston O Rings and Oiler Wick.
- 6) Using Circlip Pliers remove the Circlip from the Barrel Block. The Gland Ring can now be removed.
- 7) Unscrew Bayonet adaptor and remove Top Hat Washer.

Note: The Piston Head cannot be removed from the Piston Tube.

The Pump is now Fully dismantled.

Servicing the Pump

- 1) Remove all the Seals and carefully clean all parts of the Pump.
- 2) Inspect all components. Discard if there are signs of wear or damage.
- 3) Shake the Ball Valve. This should rattle.
- 4) Re-assemble the Pump, in the reverse order to dismantling, using new parts where necessary. Lubricate the Oiler Wick and the Gland Assembly with Fomblin.
- 5) Only use Circlips supplied by Gresham Engineering as Standard Circlips damage the Piston Tube.

Common Faults

- 1) Ball Valve the wrong way round.
- 2) Barrel End Piece loose.
- 3) Bayonet Adaptor loose.